

LC Series air controls for lift axle suspension systems



Outside mount, stainless steel box



Outside mount, composite box



Inside mount



High-performance secondary valve

Hendrickson's LC Series air control kits provide control of your lift axle in demanding applications. The speed of your lift axle raising and lowering is critical to your productivity and the service life of your vehicle. A faster lift time means that the driver can complete a maneuver more quickly to avoid "scrubbing" the tires or generating excess side loads within the lift axle suspension. A quicker deploy time means that the loads on your drive and front axles can be quickly re-established to correct levels within their rated capacities, helping to extend the life of these axles and maintain proper braking performance.

With up to a 25 percent reduction in time to lift and up to a 92 percent reduction in time to deploy compared to competitive systems, LC systems feature diaphragm valves to further enhance reliability and resistance to contamination compared to other lift axle controls with spool valves. LC kits come complete with all necessary valves and fittings needed for installation, with a variety of options available to help your fleet meet applicable regulations where you operate. The new, smaller secondary valve is now easily mounted directly onto COMPOSILITE® EX lift axle suspensions, with in-line quick exhaust valves installed at the ride air springs.



To learn more about Air Controls,
call 800.660.2829 or visit
www.hendrickson-intl.com

LC Series Air Kit Options

KIT PART NUMBER	LIFT AXLE CONFIGURATION DESCRIPTION	PRIMARY CONTROL, INSIDE MOUNT	PRIMARY CONTROL, OUTSIDE MOUNT (COMPOSITE BOX)	PRIMARY CONTROL, OUTSIDE MOUNT (STAINLESS BOX)
LC-MSI_R2	Non-Steerable	X		
LC-SSI_R2	Steerable	X		
LC-LSI_R2	Steerable: REVERSE LIFT & LOCK	X		
LC-RSI_R2	Steerable: REVERSE DOWN & LOCK	X		
LC-ASI_R2	Reverse Caster	X		
LC-UCO_R2	Non-Steerable & Steerable		X	
LC-LCO_R2	Non-Steerable & Steerable: REVERSE LIFT & LOCK		X	
LC-RCO_R2	Non-Steerable & Steerable: REVERSE DOWN & LOCK		X	
LC-ACO_R2	Reverse Caster		X	
LC-USO_R2	Non-Steerable & Steerable			X
LC-LSO_R2	Non-Steerable & Steerable: REVERSE LIFT & LOCK			X
LC-RSO_R2	Non-Steerable & Steerable: REVERSE DOWN & LOCK			X
LC-ASO_R2	Reverse Caster			X
LC-MCA_R2	Non-Steerable & Steerable: MARYLAND SPEC		X	
LC-MSO_R2	Non-Steerable & Steerable: MARYLAND SPEC			X

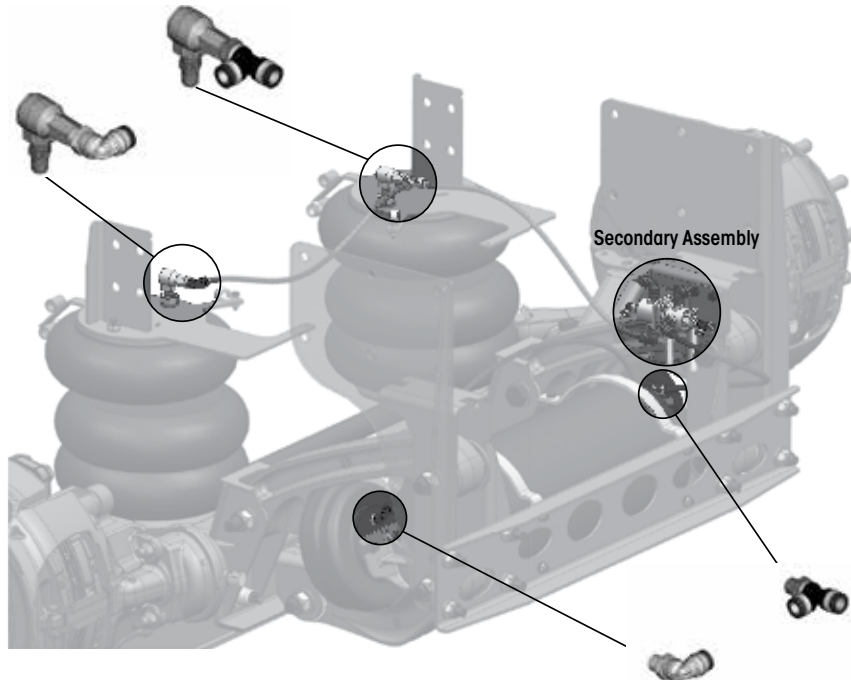

LC secondary valve shown plumbed on COMPOSITELITE® EXS13 lift axle.
Reference Hendrickson Literature No. OM-H817 (Owner's Manual - LC Auxiliary Lift Axle Control Kits)
for full installation and operation details.

*Actual product performance may vary depending upon vehicle configuration, operation, service and other factors.
All applications must comply with applicable Hendrickson specifications and must be approved by the respective vehicle manufacturer with the vehicle in its original, as-built configuration.
Contact Hendrickson for additional details regarding specifications, applications, capacities, and operation, service and maintenance instructions.*

Call Hendrickson at **800.660.2829** or **800.668.5360** in Canada for additional information.



www.hendrickson-intl.com

**SPECIALTY PRODUCTS -
AUXILIARY AXLE SYSTEMS**
277 North High Street
Hebron, OH 43025 USA
800.660.2829
740.929.5600 • Fax 740.929.5601

Hendrickson Canada
250 Chrysler Drive, Unit #3
Brampton, ON Canada L6S 6B6
800.668.5360
905.789.1030 • Fax 905.789.1033

H871 05-21

© 2021 Hendrickson USA, L.L.C. All Rights Reserved. All trademarks shown are owned by Hendrickson USA, L.L.C., or one of its affiliates, in one or more countries.
Information contained in this literature was accurate at the time of publication. Product changes may have been made after the copyright date that are not reflected.

Printed in United States of America