

H TECHNICAL PROCEDURE

PRIMAAX® EX • FIREMAAX® EX PRIMAAX® • FIREMAAX® Rear Air Suspension

SUBJECT: Pre-delivery Inspection and
Preventive Maintenance

LIT NO: 17730-266

DATE: December 2017 **REVISION:** C

IMPORTANT

INTRODUCTION

Following appropriate inspection procedures is important to help ensure the proper maintenance and operation of the suspension system and component parts. Hendrickson recommends the PRIMAAX® EX • FIREMAAX® EX | PRIMAAX® • FIREMAAX® heavy-duty rear suspension is inspected at pre-delivery, the first 1,000 miles of service and at the regular preventive maintenance intervals. Off-highway and severe service operating conditions require more frequent inspections than on-highway service operation.

Carefully inspect the suspension, refer to Hendrickson Technical Procedure publications for complete PRIMAAX EX • FIREMAAX EX PRIMAAX • FIREMAAX suspension inspection procedures, important safety notices, and preventive maintenance details, available at www.hendrickson-intl.com.

- 17730-238
- 17730-254 (Volvo)
- 17730-263 (Kenworth)
- 17730-279 (Mack)
- 17730-283 (International Truck)
- 17730-284 (Caterpillar)

NOTE

Torque values shown in this publication apply only if Hendrickson supplied fasteners are used. If non Hendrickson fasteners are used, follow the torque specification listed in the vehicle manufacturer's service manual.

SAFETY REMINDER

All applicable warnings and cautions should be read carefully to help prevent personal injury and to assure that proper methods are used. Improper maintenance, service or repair may damage the vehicle, cause personal injury, render the vehicle unsafe in operation, or void manufacturer's warranty.

Failure to follow the applicable safety precautions can result in personal injury and/or property damage. Carefully read and understand all safety related information within the applicable Hendrickson publications, on all decals and those provided by the vehicle manufacturer before operating the vehicle, or conducting any maintenance, service or repair.

⚠ CAUTION

OVERLOADED SUSPENSIONS CAN CAUSE COMPONENT FAILURE, ADVERSE VEHICLE HANDLING, SEVERE PERSONAL INJURY OR DEATH.

- DO NOT EXCEED SUSPENSION CAPACITY RATINGS.
- DO NOT OPERATE AUXILIARY LIFT AXLES OR OTHER LOAD TRANSFERRING DEVICES IN ANY WAY THAT CAN OVERLOAD THE SUSPENSION.



AREAS OF INSPECTION

The inspection must include the following components:

- Air springs
- Clamp group: Top pad • U-bolts and locknuts
- QUIK-ALIGN® connections
- Air supply and fittings
- U-beam assembly: Cross tube / Support beam / End cap (enhanced or detachable)
- S-cam support tube bracket
- All fasteners
- Frame hanger bracket
- Shock absorbers
- Tire wear
- Height control valve
- Transverse and longitudinal torque rods

- Signifies performance critical components.

HENDRICKSON RECOMMENDED INSPECTION INTERVALS

	PRE-DELIVERY INSPECTION	FIRST IN-SERVICE INSPECTION	PREVENTIVE MAINTENANCE
<p>Visual inspection for proper assembly and function. Check for all of the following and replace components as necessary:</p> <ul style="list-style-type: none"> • Signs of unusual movement, loose or missing components • Signs of abrasive or adverse contact with other components • Damaged, or cracked parts • Improper suspension function or alignment 			<p>OFF-HIGHWAY Every 6 Months/1,200 Hours or 25,000 miles/40,000 km, whichever comes first</p> <p>ON-HIGHWAY Every 12 Months or 50,000 miles, whichever comes first</p>
<p>Visually inspect the overall condition of and for any signs of damage to:</p> <ul style="list-style-type: none"> • U-beam assembly • Air springs and air lines 	<p>Within the first 500 miles (500 km)</p>	<p>Within the first 1,000 miles (1,600 km) or 100 Hours</p>	
<p>Inspect fasteners for proper torque as recommended in the Torque Specifications section in the appropriate PRIMAAX EX • FIREMAAX EX Technical Publication for your vehicle:</p> <ul style="list-style-type: none"> • QUIK-ALIGN fasteners and Torque rod to top pad fasteners, see Figure 1 • Clamp group U-bolt fasteners, see Figure 2 • DO NOT re-torque Integrated End Cap, see Figure 3 			<p>Every 12 Months / 2400 Hours</p>
<p>Verify the lateral alignment of the drive axles are within the vehicle manufacturer's tolerances</p>			
<p>Verify ride height, refer to Ride Height in the Alignment & Adjustment section in the appropriate PRIMAAX EX • FIREMAAX EX Technical Publication for your vehicle</p>			

See vehicle manufacturer's applicable publications for other preventive maintenance requirements.



NOTE

Figures 1 through 3 illustrate PRIMAAX EX • FIREMAAX EX suspension basic connections, refer to the appropriate PRIMAAX EX • FIREMAAX EX Technical Publication for your vehicle.

FIGURE 1

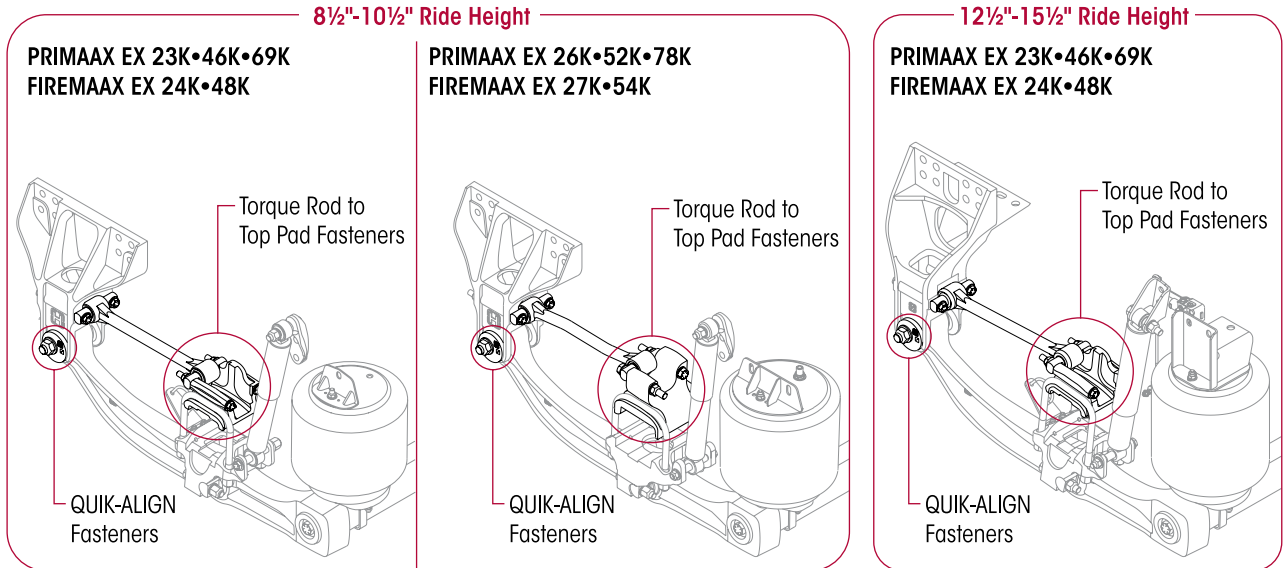

FIGURE 2

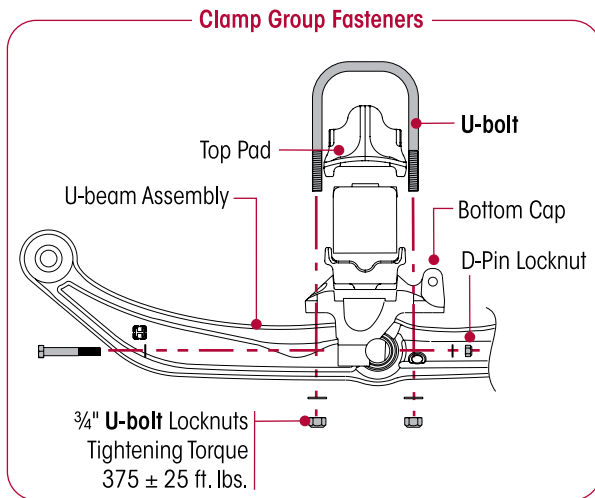
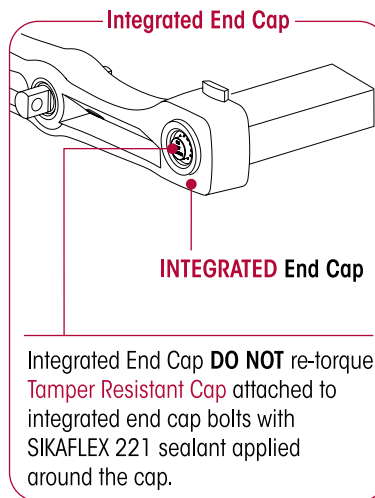

FIGURE 3



PRIMAAX • FIREMAAX • VEHICLES BUILT PRIOR TO 2009

1. Check all fasteners for proper torque with special attention to the detachable end cap connection fasteners, see Figure 4.

FIGURE 4

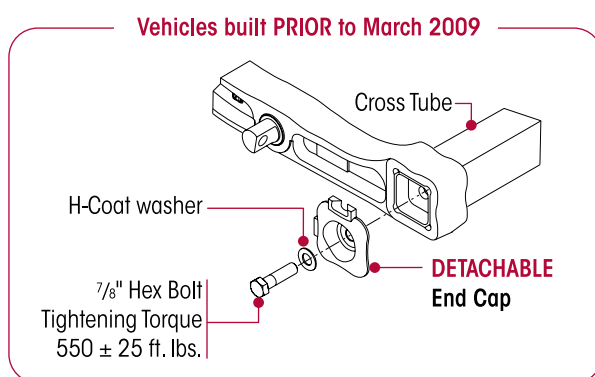



Hendrickson technical and parts support contact information:



Toll-free U.S. and Canada
1.866.755.5968
Outside U.S. and Canada
1.630.910.2800



Parts Identification
truckparts@hendrickson-intl.com
Technical Support
techservices@hendrickson-intl.com



1.630.910.2899



Additional Hendrickson
Product Information
www.hendrickson-intl.com

www.hendrickson-intl.com



Truck Commercial Vehicle Systems
800 South Frontage Road
Woodridge, IL 60517-4904 USA

1.866.755.5968 (Toll-free U.S. and Canada)
1.630.910.2800 (Outside U.S. and Canada)
Fax 1.630.910.2899